

SN 1870

Stempelführungsbuchsen
Punch guide bushes
Canons de guidage

STRACK®
NORMALIEN

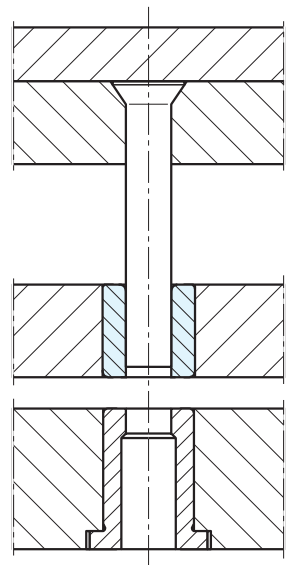
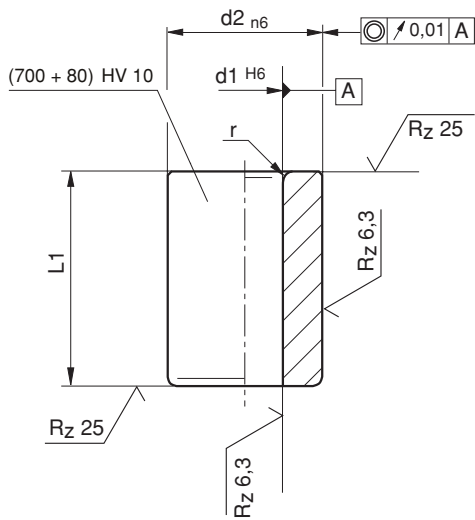

X* - Stufung in mm
- graduation in mm
- progression en mm

Mat. Werkzeugstahl
Tool steel
Acier à outils
740±40 HV 10/ISO 8978

✉ **SN 1870-**

SN 1870-d1-L1-d2



| d1 | L1 | d2 | r | X*(d1) | |
|-------------|------|----|-----|--------|--|
| 1,0 - 2,4 | 8,0 | 5 | 1,0 | 0,1 | |
| 1,6 - 3,0 | 12,5 | 6 | 1,0 | 0,1 | |
| 2,0 - 3,5 | 12,5 | 8 | 1,5 | 0,1 | |
| 3,0 - 5,0 | 16,0 | 10 | 2,0 | 0,1 | |
| 4,0 - 7,2 | 16,0 | 13 | 2,0 | 0,1 | |
| 6,0 - 8,8 | 20,0 | 16 | 2,0 | 0,1 | |
| 7,3 - 11,3 | 20,0 | 20 | 2,5 | 0,1 | |
| 11,0 - 16,6 | 25,0 | 25 | 2,5 | 0,1 | |
| 15,0 - 20,0 | 25,0 | 32 | 4,0 | 0,5 | |
| 18,0 - 27,0 | 32,0 | 40 | 4,0 | 0,5 | |